

独立差动  
适用更广



※ FW-720-TB SERIES MODELS



FL

FW-720-TB/FL

细横筒型高速三针绷缝机**附左修刀功能**  
SMALL CYLINDER-BED HIGH SPEED INTERLOCK STITCH MACHINE (LEFT KNIFE)

全新设计之 FL (左切刀) 切布边功能, 容易操作、稳定性更佳。  
适用各式针织品,T恤,汗衫之下摆工作 (附左修刀修齐布边后,再进行下摆车缝工作)。

All new designed of left hand side fabric trimmer cut the extra fabric in easily and stable.  
Applicable to all kinds of knitwear,T-shirt & Underwear for hemming stitch.(The left hand side fabric trimmer cut the extra fabric of edge to make it even for hemming.)

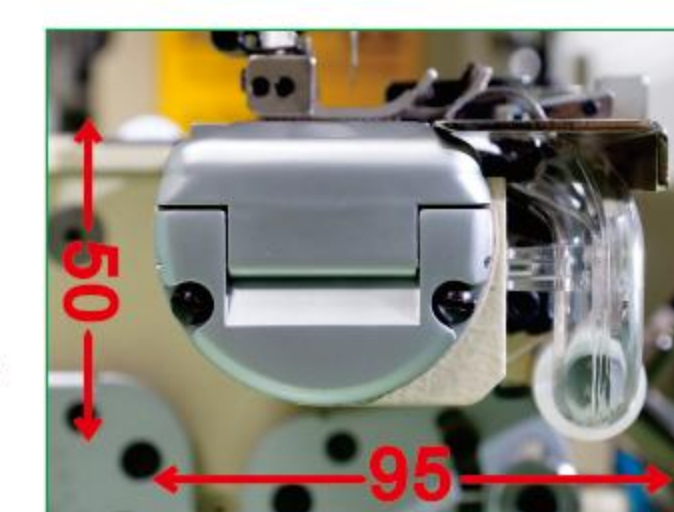

T

FW-720-TB/T

细横筒型高速三针绷缝机**附上送机构**  
SMALL CYLINDER-BED HIGH SPEED INTERLOCK STITCH MACHINE (TOPFEED)

因为上输送、下输送的驱动各自独立, 所以能保持较大的差动比,使输送效率进一步提高,因此可以解决在重缝段部的缝堵和跳线,也能实现美观的下摆折缝纫工序。

Because the upper transmission device and lower transmission device are separately, so it can keep big differential ratio then the transmission efficiency will be further raised.

【 采用专利设计的无段变速机构  
零件不易磨损, 拉力强, 更耐用 】



FW-720-TB-356/T/FL

横筒型高速三针绷缝机**附上送&左修刀功能**  
SMALL CYLINDER-BED HIGH SPEED INTERLOCK STITCH MACHINE (WITH TOPFEED & LEFT KNIFE)

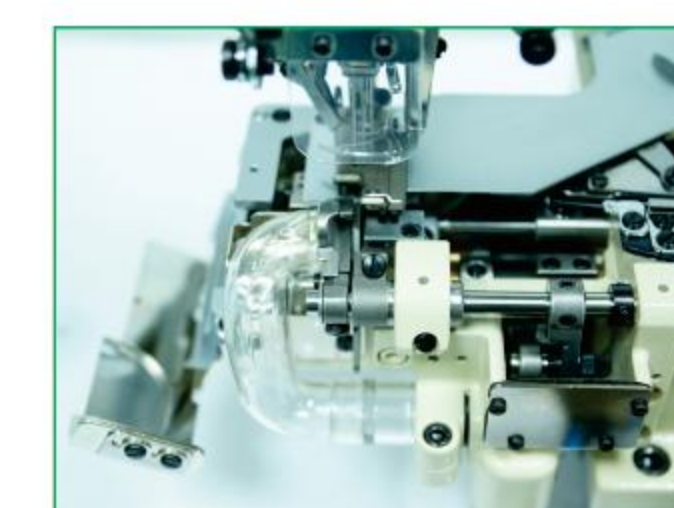

T/FL

※ SPECIFICATION

型号	针数	针距	针距	针距	针距	针距	针距
	2	3	4	5	6	7	8
	10	12	14	16	18	20	22
	24	26	28	30	32	34	36
	38	40	42	44	46	48	50
	52	54	56	58	60	62	64
	66	68	70	72	74	76	78
	80	82	84	86	88	90	92
	94	96	98	100	102	104	106
	108	110	112	114	116	118	120

DEVICE NO ※

针数 Needle	针距 Needle Gauge	辅助装置 Device
2	40	
3	56	
4	64	

FW-720-TB SERIES

细横筒型高速三针绷缝机

SMALL CYLINDER-BED HIGH SPEED INTERLOCK STITCH MACHINE



星锐缝纫机股份有限公司  
SHING RAY SEWING MACHINE CO.,LTD.  
星锐缝纫机(嘉兴)有限公司  
SHING RAY SEWING MACHINE (JIAXING) CO.,LTD.

本目录所记载的规格式样或外观, 因加以改良, 有时不预告即加以变更, 请见谅。  
This specifications is this catalog are subject to change without notifications.

2019.08.25



# FW-720-TB

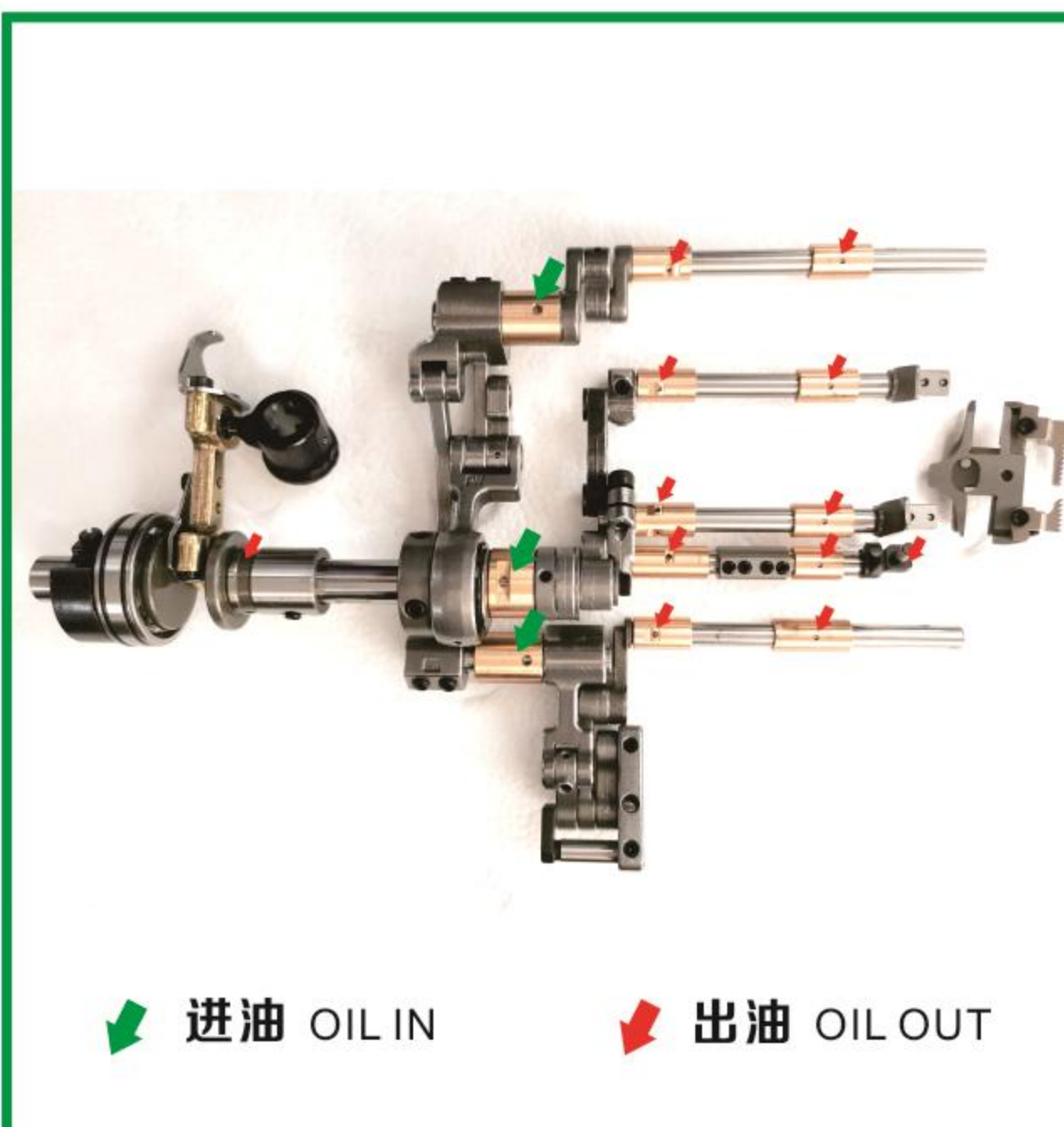

采用特殊的中空零件,内部强制给油,稳定耐用;为机器高速运转保驾护航。

## 内部零部件强制给油

Adopts special hollow parts for forced lubricant supply. It ensures machine super high speed running stably and durably.

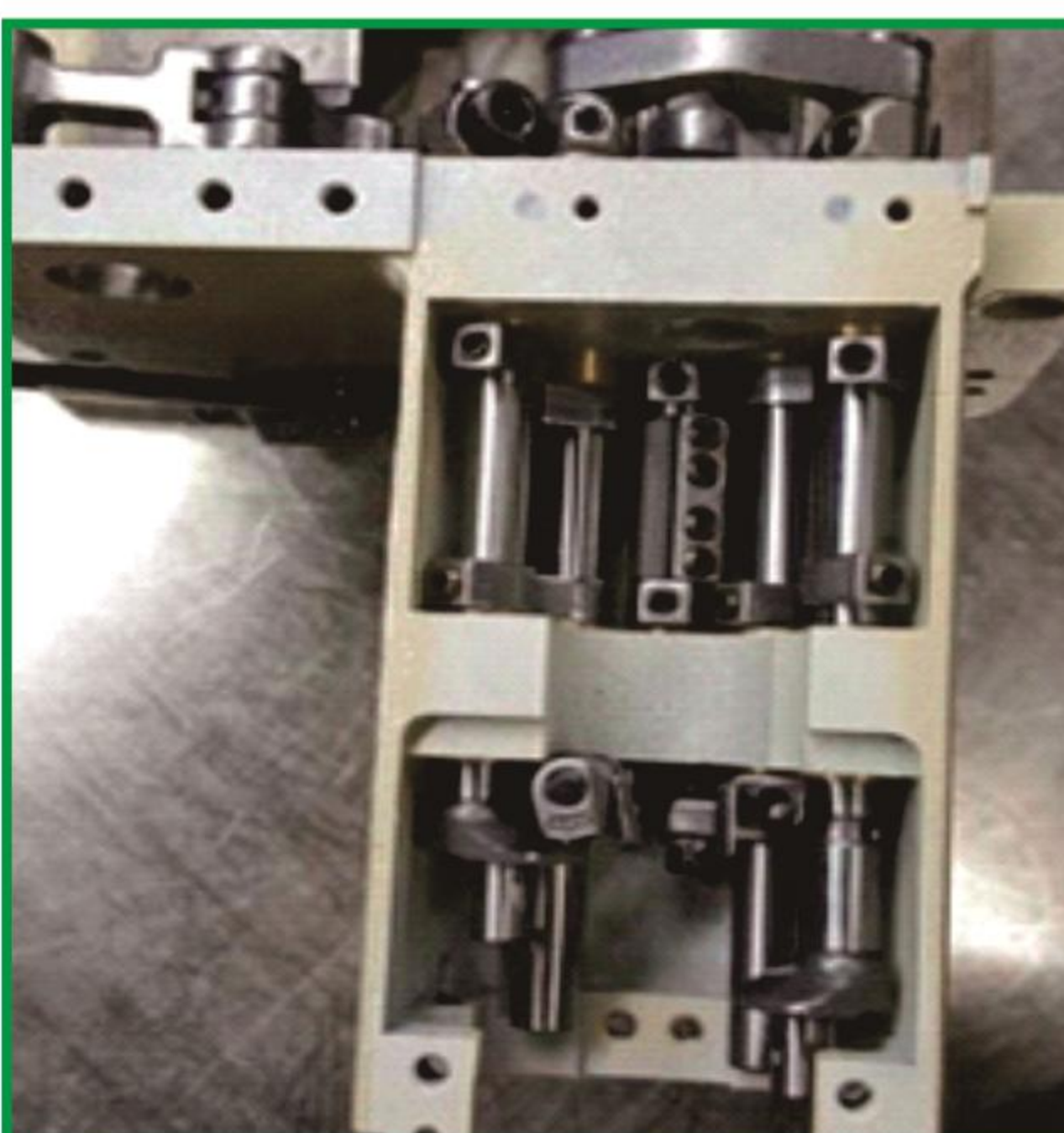

专利设计的五轴心下巴机构,结构更合理,为机器高速运转的稳定性提供了强有力的保障。

## 独创五轴心下巴机构

Patented 5-shaft cylinder bed mechanism is a more reasonable structure. It ensures stability at machine high speed running.



## 独立差动调整机构

采用专利设计的摇杆式独立差动调整机构,提供充分的差动进给量,轻松应对各种面料。

Patented rocker-type independent differential feed adjustment mechanism provides sufficient differential feed ratio to handle a big variety of fabrics easily.

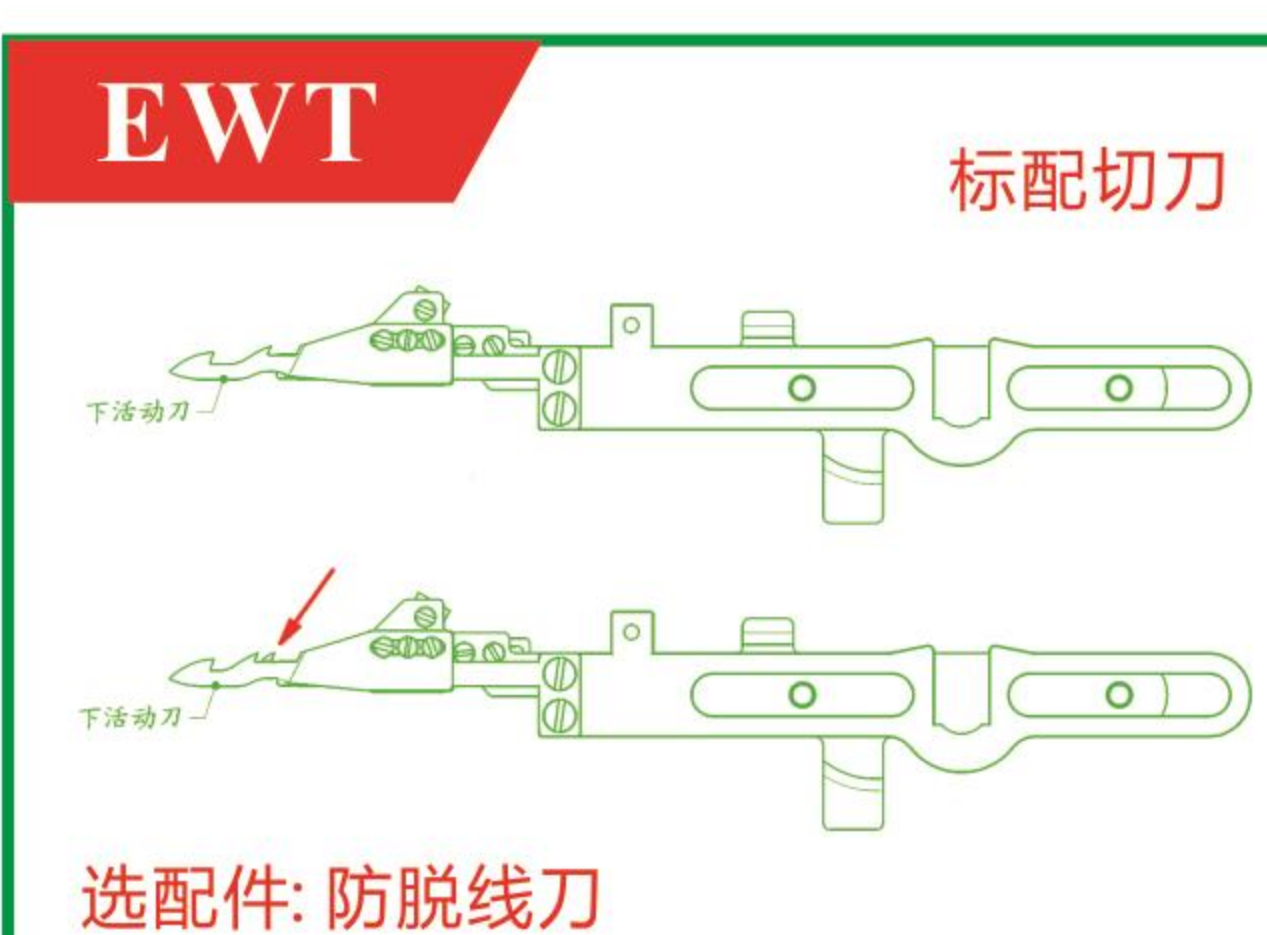

选配件: 防脱线刀

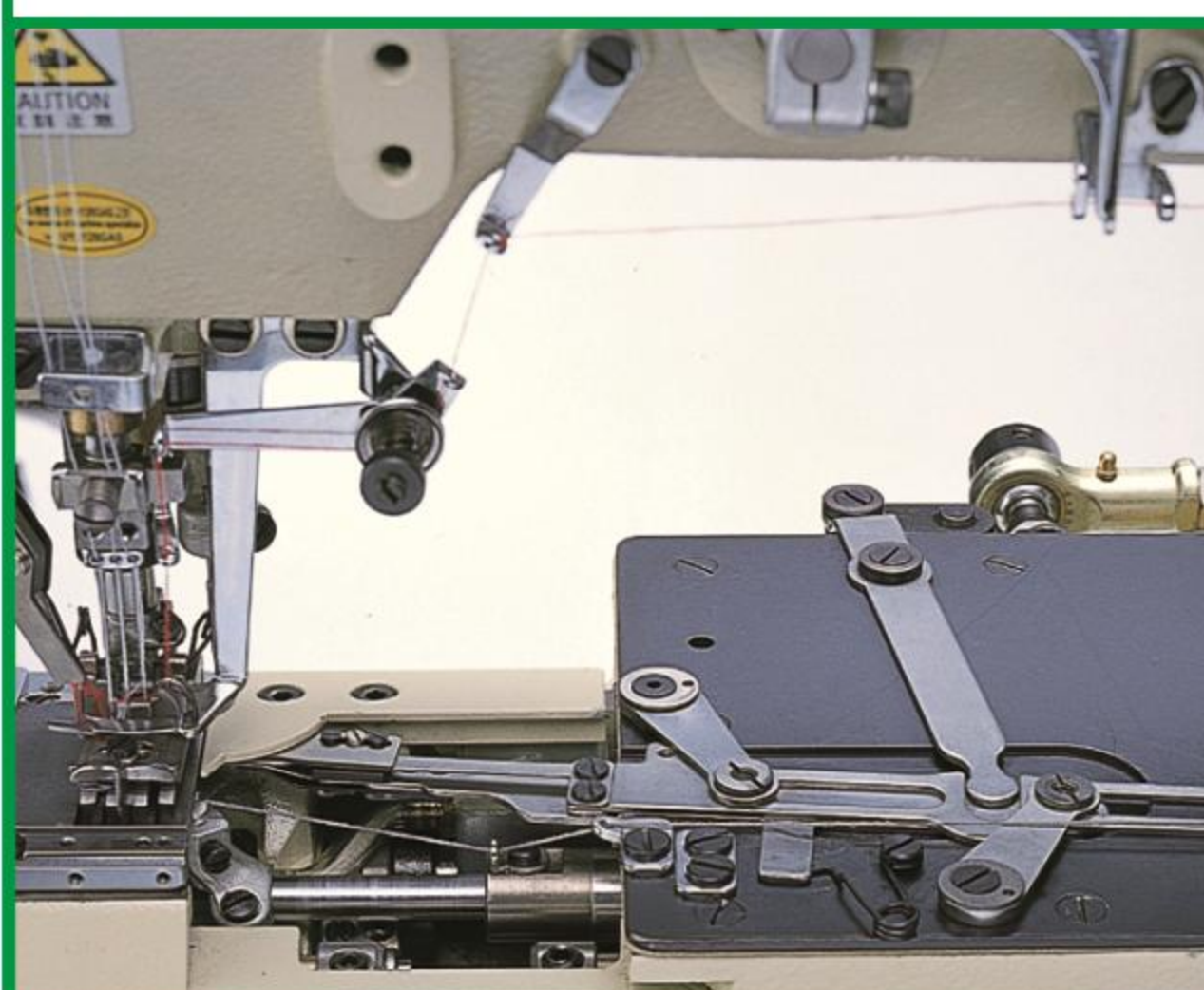

## 微调式底线切线组

Patented Bottom Thread Cutter is easy to be adjusted perfectly. It cuts thread very stable. Brand new designed optional bottom thread knife effectively prevents skip-thread.

(optional: Anti-skip-thread knife)



## 多向可调式上饰线切线组

专利设计的上饰线切线刀,可依使用者之需求调整至最佳切线角度。

The patent design top thread trimmer could follow user requested to adjust any precise cutting angle.

(台湾专利字第135363号)



## 拨线+自动剪线(可选配)

拨线、自动剪线可同时加装,不漏针,不脱线,线头更适宜,转弯更顺畅。

Both Thread Wiper and Cutter can be installed on one machine at the same time, no skip stitches, nice thread end and smooth stitches turning.

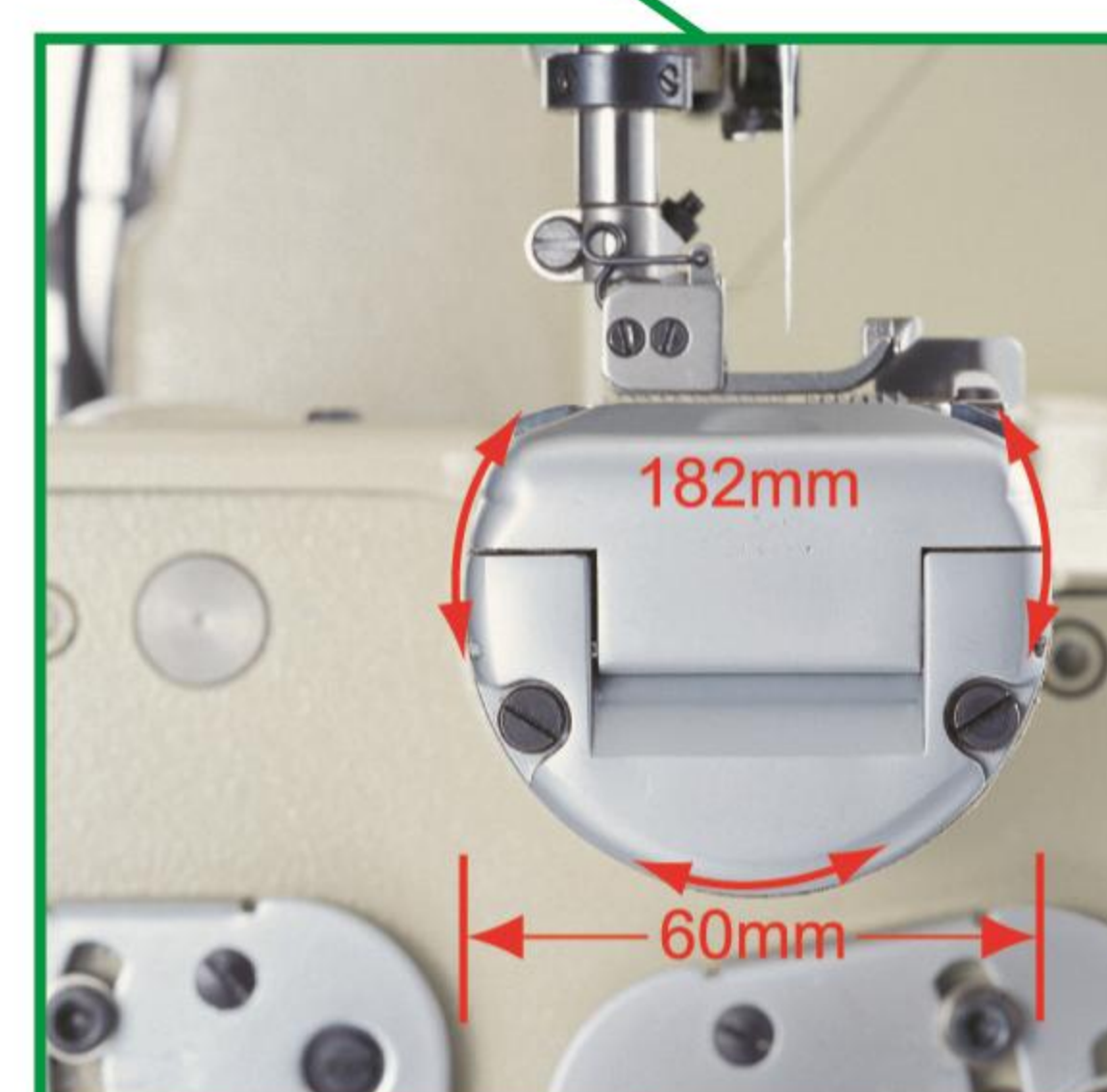

## 细筒型设计

采用圆周182mm的细筒型设计,车缝小口径的圆筒型针织物,更加便利。

The small cylinder designed which circumference are 182mm, to sews small-sized tubular goods more conveniently.



## 新型陶瓷过线结构

With the special Ceramic Threading structure, threading is simple and the thread goes smoothly. It effectively increases machine durability.



微型电控与机头完美结合,除了美观、操作方便,更使得操作空间加大。

## 创新机电一体技术

The micro-electric control is perfectly combined with the machine head on the table. In addition to the beautiful appearance and convenient operation, the operation space is increased.

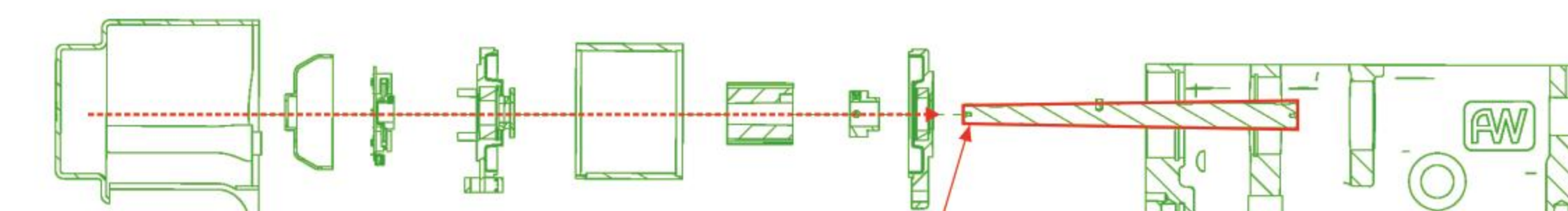

主轴与马达同轴驱动 (锥形主轴更稳定)

## 专利设计的无心马达

采用专利设计的无心马达,主轴与马达同轴驱动平衡系数更高,性能更稳定;

Patented Centerless Motor enable machine head and motor use the Same Spindle. The drive balance coefficient is higher and machine performance is even more stable.

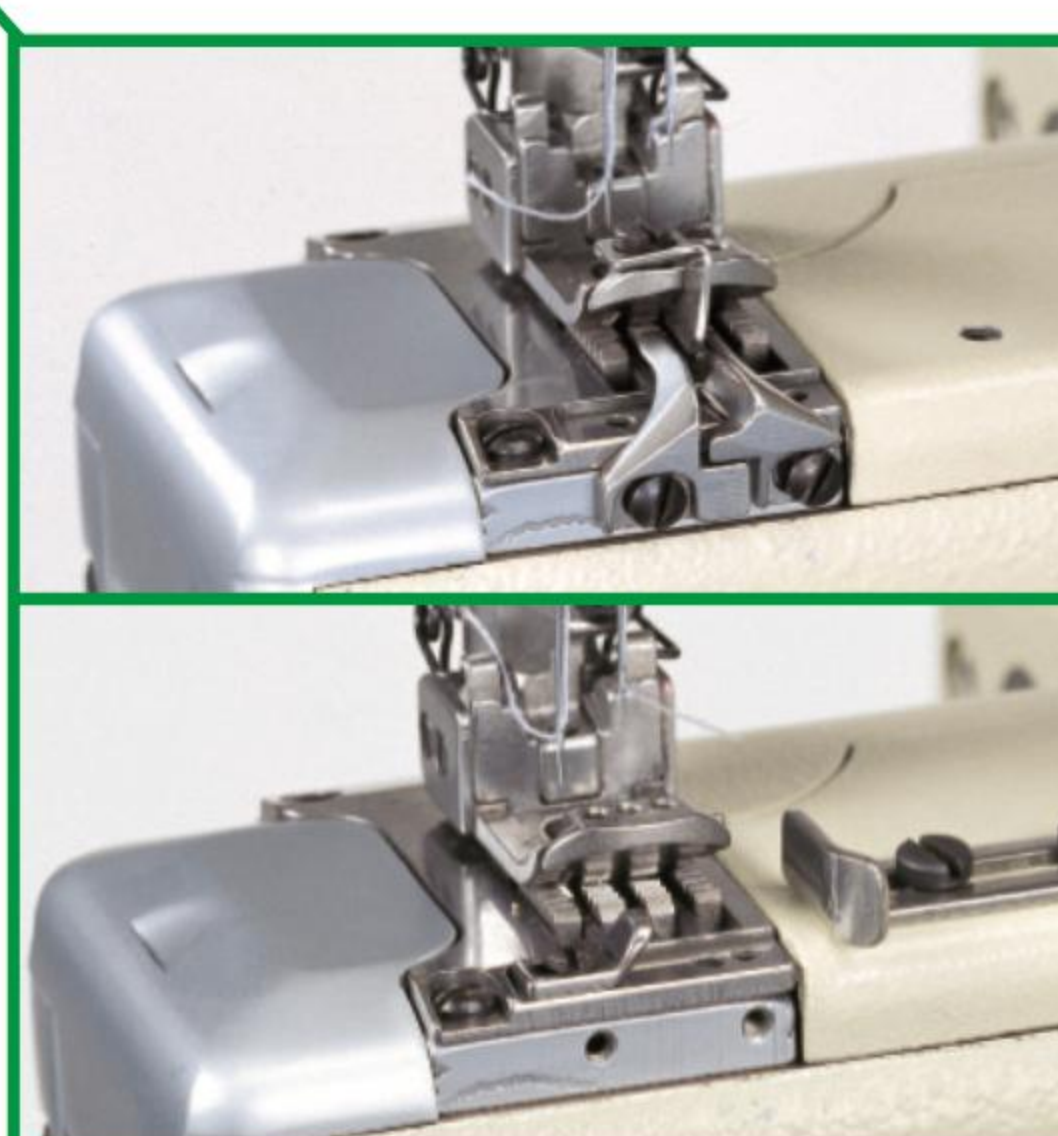

## 牛角式布诱导器 / 可调式折边器

牛角式布诱导器使埋压拷克骨更为稳定; 简易可调式折边器,轻易切换折边缝功能。

Horn type Regulating fabric guider, to offer stable covering stitch. Adjustable hemming folder, it's easily to change the hemming function.



## 新增 LED 照明

新增LED照明,具5程式亮度调节,可满足不同亮度需求,避免视觉疲劳;

New LED lighting, 5 kinds of brightness adjustment, can meet different brightness needs, avoid visual fatigue.